

REINFORCED CONCRETE PIPE MITER BEND

PIPE DIA. (INCHES)	R.C.P. PIPE (MAX DEFLECTION PER JOINT)	MINIMUM BAND THICKNESS ("A" IN)
24" & SMALLER	1° 30'	1 1/2"
30" TO 48"	1° 0'	2"
54" TO 60"	0° 45'	2 1/2"
66" & LARGER	0° 30'	3"

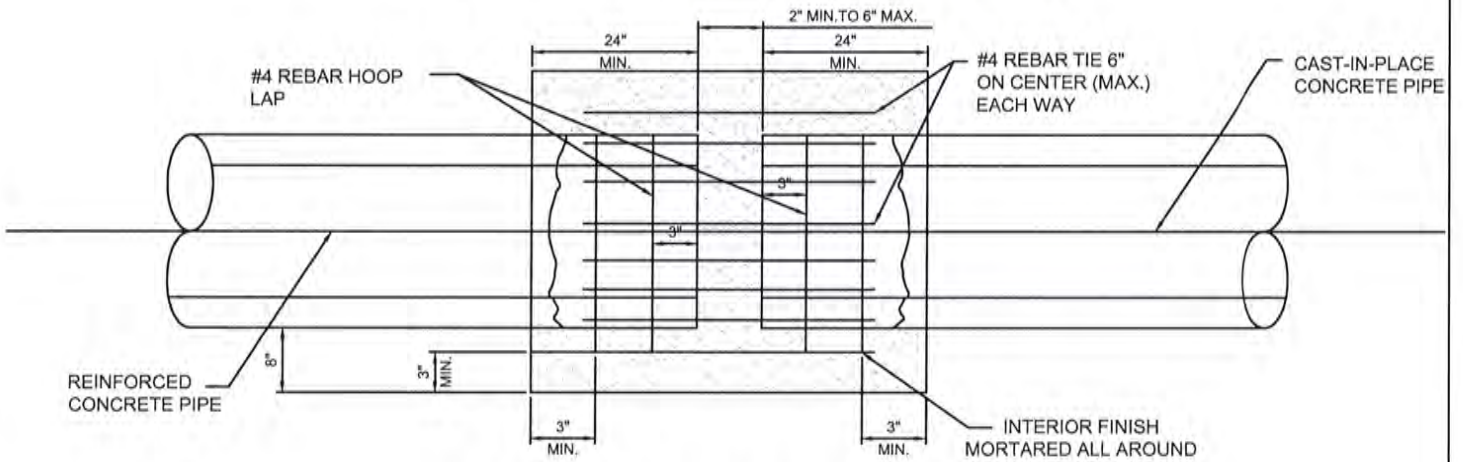

STORM DRAIN TRANSITION CONNECTION

NOTES:

1. REINFORCED CONCRETE PIPE (R.C.P.) SHALL HAVE A MINIMUM OF CLASS III RATING.
2. MITER END SHALL BE PRECAST IN PIPE (CUTTING OF PIPE SHALL BE ALLOWED WITH AGENCY ENGINEER APPROVAL).
3. SEE MANUFACTURER'S SPECIFICATION FOR MAXIMUM DEFLECTION PER JOINT, AND MINIMUM RADIUS OF CAST-IN-PLACE PIPE.
4. MORTAR SHALL BE CLASS "C" PCC.
5. CONCRETE SHALL BE CLASS 470-C-2000.
6. A STORM DRAIN MANHOLE IS REQUIRED IF MORE THAN 22 1/2° DEFLECTION.
7. THE USE OF THIS STANDARD PLAN SHALL REQUIRE APPROVAL OF THE CITY ENGINEER.

TITLE:

STORM DRAIN COLLAR

DRAWN BY: STAFF
 SCALE: NONE
 REVIEWED BY: DANNY HILLSTOCK
 REVISED: OCTOBER, 2019

APPROVED:
Danny Hillstock 11-5-19
 CITY ENGINEER, DANNY HILLSTOCK LIC. NO. 70647 DATE

STANDARD PLAN
D-5
 SHEET 1 OF 1

CITY OF HOLLISTER
 ENGINEERING DEPARTMENT